



ecocirc XL and XLplus

SINGLE AND TWIN HEAD HIGH EFFICIENCY CIRCULATORS IN CAST IRON OR STAINLESS STEEL FOR HOT AND COLD HVAC APPLICATIONS

Exactly what you need from a circulator.

At Xylem we believe in products that do their job when expected with easy to install, commission, operate and service. When it comes to circulators, that means: high efficiency, robust design and high precision manufacturing as well as well thought through controls and communication.

A product for many years of trouble free operation. This is exactly what the ecocirc XL and XLplus will offer.

Keep it hot.

A moulded insulation shell keeps the temperature of the pumped liquid (and the surroundings) where it should be.

Low cost of operation.

Your operation costs are kept to a minimum thanks to a high efficiency ECM motor and hydraulics with an EEI that is even better than the ErP 2015 level.



The Brain

Maximum flexibility. ecocirc XL can be operated in 4 different functional modes:

- Automatic proportional pressure (Δp_v)
- Constant pressure (Δp_c)

- Constant speed
- Night Mode

ecocirc XLplus version can be operated with additional functional mode based on differential temperature controls for additional energy savings.



Easy to operate.

With only four logically placed buttons, it's easy to set up and operate the new ecocirc XL. You can access its advanced settings from a PC, tablet or smartphone via built-in communication BUS or Wi-Fi (optional module).

Visible in dark plant rooms.

Clear display with large figures and symbols makes it easy to read the values, even in the dark.



Flexibility.

Two analogue inputs for 4-20mA and 0-10V signals and one temperature probe.

Safe.

The built in dry run protection stops the pump and prevents damage if it runs without water.

Chilled water no problems.

The electronics are separated from the pump to prevent condensation problems when pumping chilled liquids.

Advanced settings programmable via PC, tablet or smartphone.
Accessible via built-in communication BUS (via cable) or Wi-Fi (optional module).

Maximum security.

If something unexpected happens; alarm and error codes show on the display and are stored in an error log. You will always know exactly what happened and when.

Maximum control.

There are two analogue inputs for 4-20 mA or 0-10V plus an auxiliary temperature probe.

The ecocirc XLplus communicates with BMS systems via Modbus RTU and BACnet.

Runtime data is stored for optimising settings.

Benefit from a full performance coverage with only a few models.

The selection process is easier, it's easier to standardize in a building and replacement pumps are always in stock.

With a temperature range from -10°C to $+110^{\circ}\text{C}$, the standard ecocirc XL and XLplus fits in both hot and cold water systems, including tap hot water, geothermal and solar systems.

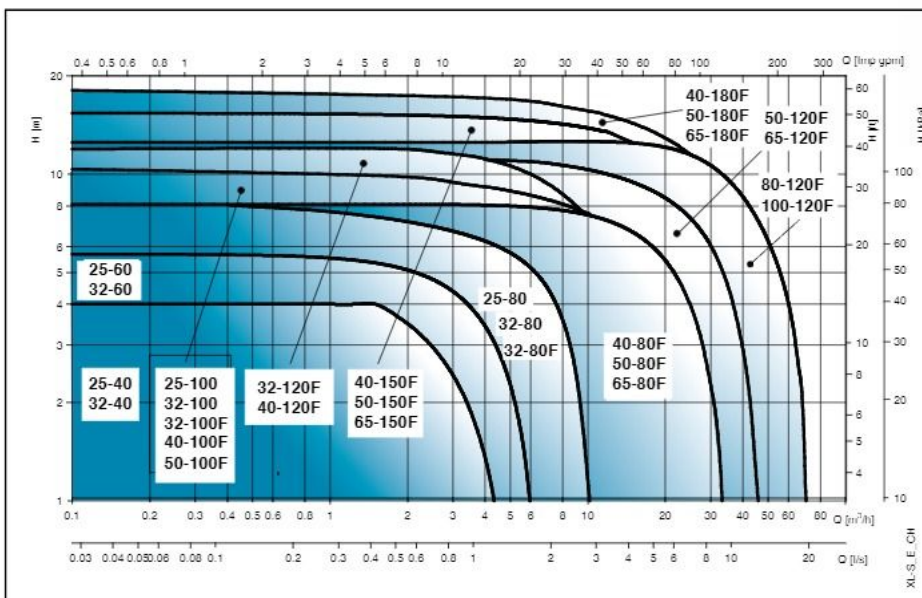

ecocirc XL and XLplus

Two Versions.

ecocirc XL

The stand-alone version without communication capabilities.

ecocirc XLplus

The full featured version including built-in communication protocols for BMS systems and designed for Wi-Fi communication (optional module).



	ecocirc XL	ecocirc XLplus
Control Modes		
Proportional Pressure	•	•
Constant Pressure	•	•
Constant Speed	•	•
Constant and differential temperature		•
Night Mode	•	•
Readings and settings on the pump		
Control panel and display	•	•
Operating status	•	•
Warning and alarm	•	•
Errors and work log history		•
Dry run protection	•	•
Input/Output		
2 x Analogue inputs (0-10V / 4-20mA)	•	•
1 x Aux temperature sensor		•
1 x start/stop digital input	•	•
1 x signaling digital output	•	•
Two pump operation		
Communication between two pumps		•
Alternating operation		•
Backup operation		•
Cascade operation (constant curve)	• (manual)	•
Communication and monitoring		
Communication with BMS		•
Communication with PC/Laptop		•
Wi-Fi module for wireless communication		•

There's always an exact match to your needs.

Model	Connection	Port-to-Port (mm)	Twin head	Stainless Steel	Electrical connection
ecocirc XL - XLplus 25-40	G 1 ½ - Rp 1	180		x	plug
ecocirc XL - XLplus 25-60	G 1 ½ - Rp 1	180		x	plug
ecocirc XL - XLplus 25-80	G 1 ½ - Rp 1	180			terminals
ecocirc XL - XLplus 25-100	G 1 ½ - Rp 1	180			terminals
ecocirc XL - XLplus 32-40	G 2 - Rp 1 ¼	180		x	plug
ecocirc XL - XLplus 32-60	G 2 - Rp 1 ¼	180		x	plug
ecocirc XL - XLplus 32-80	G 2 - Rp 1 ¼	180	x	x	terminals
ecocirc XL - XLplus 32-100	G 2 - Rp 1 ¼	180	x	x	terminals
ecocirc XL - XLplus 32-80 F	DN 32	220	x		terminals
ecocirc XL - XLplus 32-100 F	DN 32	220	x		terminals
ecocirc XL - XLplus 32-120 F	DN 32	220	x	x	terminals
ecocirc XL - XLplus 40-80 F	DN 40	220	x		terminals
ecocirc XL - XLplus 40-100 F	DN 40	220	x		terminals
ecocirc XL - XLplus 40-120 F	DN 40	250	x	x	terminals
ecocirc XL - XLplus 40-150 F	DN 40	250	x		terminals
ecocirc XL - XLplus 40-180 F	DN 40	250	x		terminals
ecocirc XL - XLplus 50-80 F	DN 50	240	x	x	terminals
ecocirc XL - XLplus 50-100 F	DN 50	280			terminals
ecocirc XL - XLplus 50-120 F	DN 50	280	x	x	terminals
ecocirc XL - XLplus 50-150 F	DN 50	280			terminals
ecocirc XL - XLplus 50-180 F	DN 50	280			terminals
ecocirc XL - XLplus 65-80 F	DN 65	340	x	x	terminals
ecocirc XL - XLplus 65-120 F	DN 65	340	x	x	terminals
ecocirc XL - XLplus 65-150 F	DN 65	340			terminals
ecocirc XL - XLplus 65-180 F	DN 65	340			terminals
ecocirc XL - XLplus 80-120 F	DN 80	360	x		terminals
ecocirc XL - XLplus 100-120 F	DN 100	360			terminals

Specifier's Tools.

Xylem offer great online and off-line tools to make a specifier's life easier and for better performance. They are easy to use and minimize the risk of making mistakes in the selection process.

The selection software comes in stand-alone (Loop4U) or web based (xylect.com) versions and allows you to find the best solutions for your pumping problems even without knowing the Xylem product portfolio.

The software let's you search on duty point, application or browse by product.

Detailed output from our tools includes downloadable documents such as data sheets and dimensional drawings in dxf, stp or revit formats.

Besides a comprehensive range of software, Xylem offers a whole range of systems engineering tools for sizing a pump system as well as training in pump sizing and pump systems optimization. And if you need further help, Xylem also has skilled application engineers ready to assist you in designing optimal pumping systems.

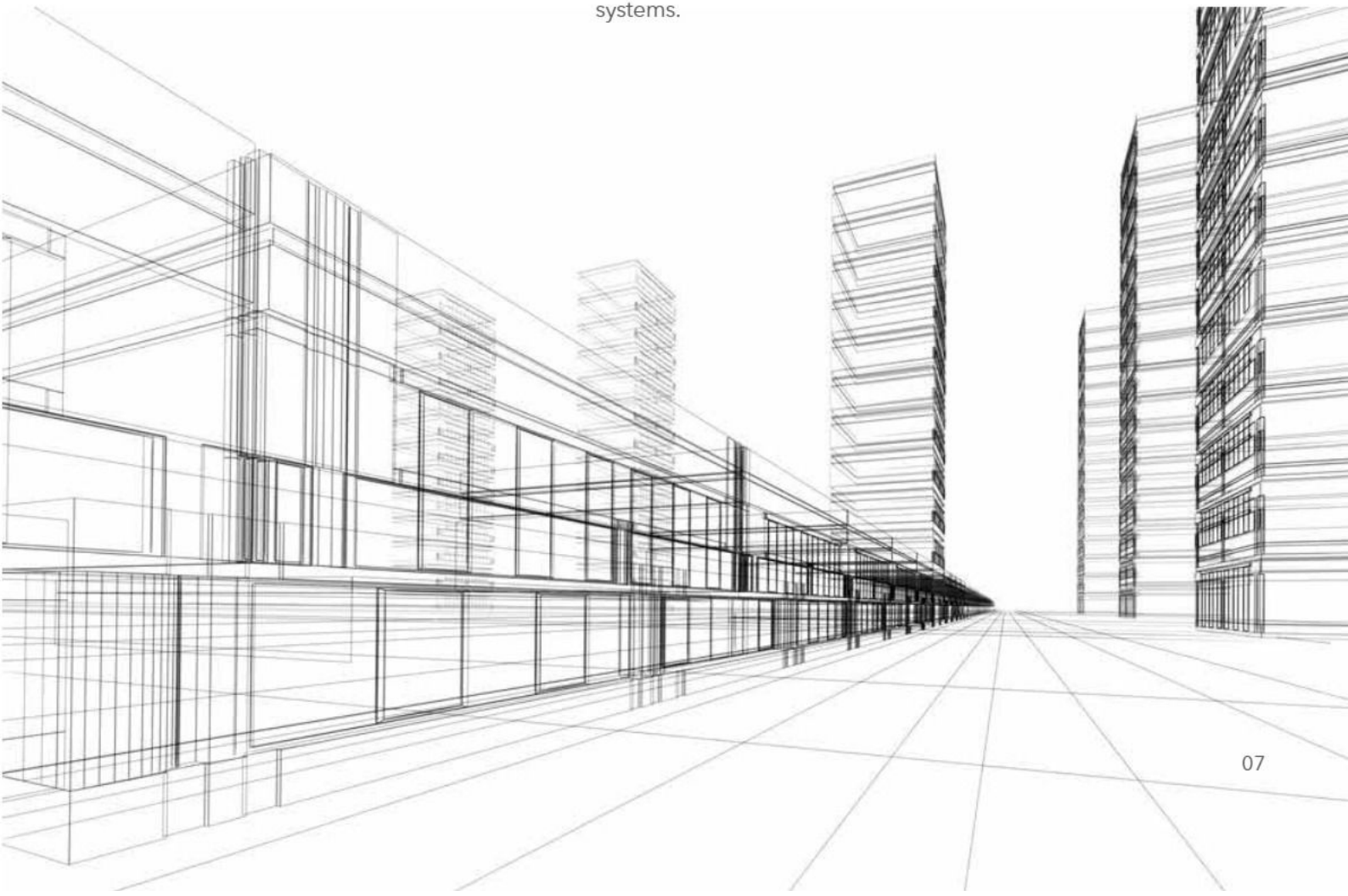

Xylem |'zīləm|

- 1) The tissue in plants that brings water upward from the roots;
- 2) a leading global water technology company.

We're a global team unified in a common purpose: creating advanced technology solutions to the world's water challenges. Developing new technologies that will improve the way water is used, conserved, and re-used in the future is central to our work. Our products and services move, treat, analyze, monitor and return water to the environment, in public utility, industrial, residential and commercial building services, and agricultural settings. With its October 2016 acquisition of Sensus, Xylem added smart metering, network technologies and advanced data analytics for water, gas and electric utilities to its portfolio of solutions. In more than 150 countries, we have strong, long-standing relationships with customers who know us for our powerful combination of leading product brands and applications expertise with a strong focus on developing comprehensive, sustainable solutions.

For more information on how Xylem can help you, go to www.xylem.com



Legal head office
Xylem Water Solutions Italia Srl

Via Gioacchino Rossini 1/A
20020 - Lainate (MI) - Italy
Tel. (+39) 02 90358.1
Fax (+39) 02 9019990
www.xylemwatersolutions.com

For information and technical support
Xylem Service Italia Srl

Via Dottor Vittorio Lombardi 14
36075 - Montecchio Maggiore (VI) - Italy
Tel. (+39) 0444 707111
Fax (+39) 0444 491043
www.lowara.com

Xylem Water Solutions Italia Srl reserves the right to make modification without prior notice.
Lowara, Xylem are trademarks of Xylem Inc. or one of its subsidiaries.
© 2017 Xylem, Inc.

cod. 191007201 - P04/17