

# ECH

## Stainless Steel Horizontal Multistage Pump



### Application

- It is applicable to household water supply, equipment support, pipeline pressurization, garden watering, vegetable greenhouse watering, fish farming and poultry raising, industrial and mining, water supply and drainage of enterprises and high-rise buildings, central air conditioner and centralized heating circulation system, etc.

### Pump

- AISI 304 shaft
- Max. liquid temperature: +85°C
- Altitude: up to 1000 m
- Max. suction: 8 m
- Max. inlet pressure: limited by max. operating pressure
- Max. operation pressure: 10 bar
- Liquid PH value: 4 - 10

### Motor

- Motor with copper winding
- Built-in thermal protector for single phase motor
- Insulation class: F
- Protection class: IP55
- Max. ambient temperature: +40°C

### Identification Codes

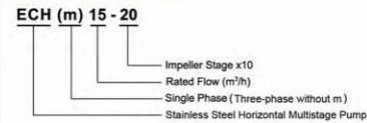

### Technical Data

Model	Power		Q (m <sup>3</sup> /h)		9		12		15		18		21	
	kW	HP	Q (l/min)	H (m)	12.4	11.6	10.6	9.4	8.2	25.6	24.1	22.7	21.1	18.8
ECH(m)15-10	1.1	1.5												
ECH(m)15-20	2.2	3												
ECH15-30	3.0	4												
ECH15-40	4.0	5.5												

### Dimension

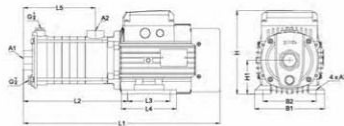

Model	L1	L2	L3	L4	L5	B1	B2	H	H1	A1	A2	A3
ECH(m)15-10	451	233.5	100	130	139.5	165	125	204.5	80	G2	G2	Φ10
ECH(m)15-20	510	222	125	150	139.5	180	140	217.5	90	G2	G2	Φ10
ECH15-30	560	272	125	150	189.5	180	140	247.5	90	G2	G2	Φ10
ECH15-40	616	336.5	140	180	230	205	160	224.5	100	G2	G2	Φ12

### Hydraulic Performance Curves

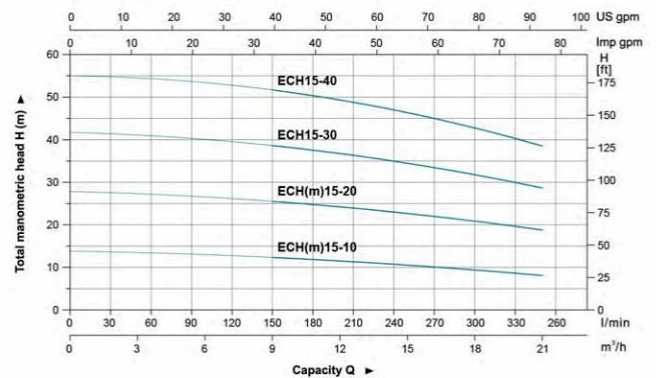

### Materials Table

No.	Part	Material
1	Fan cover	DPF
2	Fan	PP
3	Rear cover	ZL 102
4	Rotor	
5	Bearing	
6	Terminal box	ZL 102
7	Stator	
8	Front cover	Cast iron
9	Outlet body	Cast iron
10	Mechanical seal	SiC/Carbon
11	Positioning sleeve	AISI 304
12	Diffuser	AISI 304
13	Sleeve	AISI 304
14	Impeller	AISI 304
15	Pump body	Cast iron

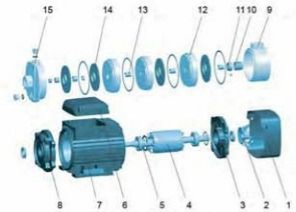

### Package Information

Model	GW (kg)	L (mm)	W (mm)	H (mm)	Quantity (PCS/20' FCL)
ECH(m)15-10	22.7	503	235	268	856
ECH(m)15-20	30.3	557	245	283	659
ECH15-30	32.2	618	245	283	620
ECH15-40	39.6	687	245	290	504

