



Applications

- Drainage of wastewater from the attenuation tank, purifying tank and sewage tank in water treatment plant
- Drainage of waste water containing fibrous additives from leather factory and food processing factory.
- Sewage management, accumulated water, septic tank, stock farm.
- Pumping sewage from hotels, restaurants, schools and public buildings

Features

- High efficient and anti-clogging Enclosed Channel impeller design
- Flexible installations with hoses, pipes or quick-coupling systems
- Flow switch included for single phase pump with motor power ≤ 1.1 kW

Working Conditions

- Liquid temperature: 0 - 40 °C
- Max immersion depth: 5 m

Motor

- Frequency/Pole number: 50 Hz/2
- Insulation class: F
- Protection class: IPX8
- Bearing: Ball type
- Mechanical seal: Double-end mechanical seals

Identification Codes

50 SW E m 8 - 16 - 1.1

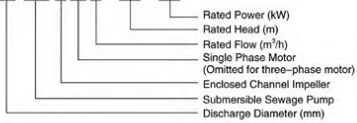

(Hose coupling as standard.
Flange elbow is available on request.)

Technical Data

Model		Power		Discharge mm (inch)	Rated Flow m ³ /h	Rated Head m	Solid Passage mm
Single Phase	Three Phase	kW	HP				
50SWE m8-16-1.1	50SWE8-16-1.1	1.1	1.5	50 (2")	8	16	15
50SWE m8-20-1.5	50SWE8-20-1.5	1.5	2	50 (2")	8	20	15
50SWE m15-20-2.2	50SWE15-20-2.2	2.2	3	50 (2")	15	20	25
-	50SWE15-25-3	3	4	50 (2")	15	25	25

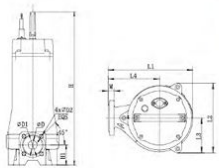

Dimension

Model	L1	L2	L3	L4	H	H1	D	D1	D2	M
50SWE8-16-1.1					559					
50SWE m8-16-1.1						88	50	110	14	16
50SWE8-20-1.5	223	191	96	135	588					
50SWE m8-20-1.5					627					
50SWE15-20-2.2					570					
50SWE m15-20-2.2	270	223	113	163	611	75	50	110	14	16
50SWE15-25-3					559					

Hydraulic Performance Curves

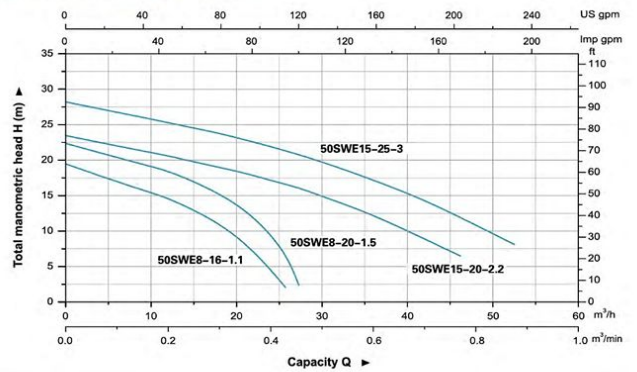

Materials Table

No.	Part	Material
1	Handle	Z23394
2	Upper cover	HT200
3	Upper bearing seat	HT200
4	Motor body	HT200
5	Oil chamber	HT200
6	Pump cover	HT200
7	Pump body	HT200
8	Impeller	HT200
9	Oil seal	
10	Mechanical seal	Water Seal Center
11	Bearing	
12	Rotor	
13	Stator	

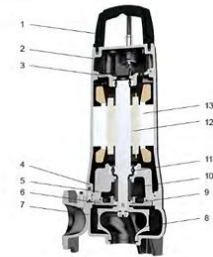

Package Information

Model	GW (Kgs)	L (mm)	W (mm)	H (mm)	Quantity (PCS/20' TEU)
50SWE8-16-1.1	39.3	750	290	368	372
50SWE m8-16-1.1	42.5	750	290	368	372
50SWE8-20-1.5	50.5	848	358	311	294
50SWE m8-20-1.5	53	848	358	311	294
50SWE15-20-2.2	56	848	358	311	294
50SWE m15-20-2.2	57	848	358	311	294
50SWE15-25-3	62	848	358	311	294



Applications

- Drainage of wastewater from the attenuation tank, purifying tank and sewage tank in water treatment plant
- Drainage of waste water containing fibrous additives from leather factory and food processing factory.
- Sewage management, accumulated water, septic tank, stock farm.
- Pumping sewage from hotels, restaurants, schools and public buildings

Features

- High efficient and anti-clogging Enclosed Channel impeller design
- Flexible installations with hoses, pipes or quick-coupling systems
- Flow switch included for single phase pump with motor power ≤ 1.1 kW

Working Conditions

- Liquid temperature: 0 - 40 °C
- Max immersion depth: 5 m

Motor

- Frequency/Pole number: 50 Hz/2
- Insulation class: F
- Protection class: IPX8
- Bearing: Ball type
- Mechanical seal: Double-end mechanical seals

Identification Codes

65 SWE m 15 - 10 - 1.1

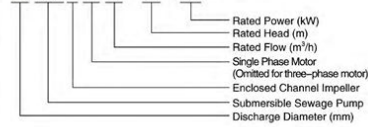

(Hose coupling as standard.
Flange elbow is available on request.)

Technical Data

Model		Power		Discharge mm (inch)	Rated Flow (m ³ /h)	Rated Head (m)	Solid Passage (mm)
Single Phase	Three Phase	kW	HP				
65SWE m15-10-1.1	65SWE15-10-1.1	1.1	1.5	65 (2.5")	15	10	25
65SWE m15-15-1.5	65SWE15-15-1.5	1.5	2	65 (2.5")	15	15	25
-	65SWE25-17-2.2	2.2	3	65 (2.5")	25	17	25
-	65SWE25-22-3	3	4	65 (2.5")	25	22	25
-	65SWE25-27-4	4	5.5	65 (2.5")	25	28	25

Dimension

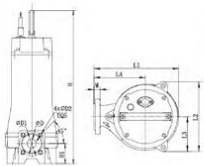

Model	L1	L2	L3	L4	H	H1	D	D1	D2	M
65SWE15-10-1.1					557					
65SWE m15-10-1.1					581					
65SWE15-15-1.5					581					
65SWE m15-15-1.5	291	226	117	178	622	85	65	130	14	16
65SWE25-17-2.2					581					
65SWE25-22-3					610					
65SWE25-27-4					610					

Hydraulic Performance Curves

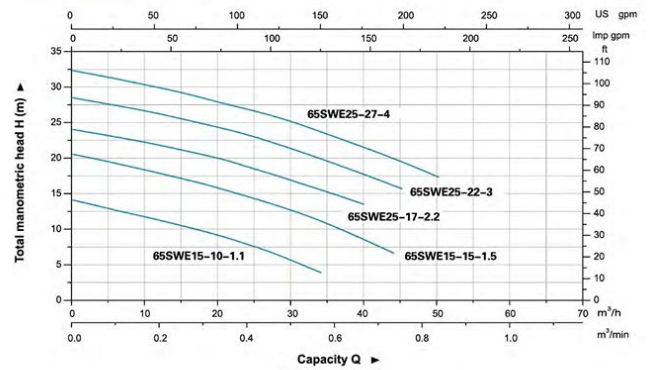

Materials Table

No.	Part	Material
1	Handle	Z5304
2	Upper cover	HT200
3	Upper bearing seat	HT200
4	Motor body	HT200
5	Oil chamber	HT200
6	Pump cover	HT200
7	Pump body	HT200
8	Impeller	HT200
9	Oil seal	
10	Mechanical seal	User Select
11	Bearing	
12	Rotor	
13	Stator	

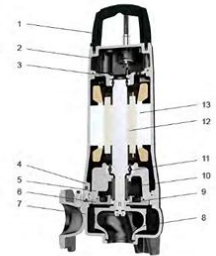

Package Information

Model	GW (Kg)	L (mm)	W (mm)	H (mm)	Quantity (PCS/22 TEU)
65SWE15-10-1.1	48	750	290	368	372
65SWE m15-10-1.1	48	750	290	368	372
65SWE15-15-1.5	57	848	290	368	372
65SWE m15-15-1.5	60	848	290	368	372
65SWE25-17-2.2	61	848	358	311	294
65SWE25-22-3	67	848	358	311	294
65SWE25-27-4	68	848	358	311	294



Applications

- Drainage of wastewater from the attenuation tank, purifying tank and sewage tank in water treatment plant
- Drainage of waste water containing fibrous additives from leather factory and food processing factory
- Sewage management, accumulated water, septic tank, stock farm.
- Pumping sewage form hotels, restaurants, schools and public buildings

Features

- High efficient and anti-clogging Enclosed Channel impeller design
- Flexible installations with hoses, pipes or quick-coupling systems

Working Conditions

- Liquid temperature: 0 - 40 °C
- Max immersion depth: 5 m

Motor

- Frequency/Pole number: 50 Hz/2
- Insulation class: F
- Protection class: IPX8
- Bearing: Ball type
- Mechanical seal: Double-end mechanical seals

Identification Codes

80 SW E 40 - 9 - 2.2

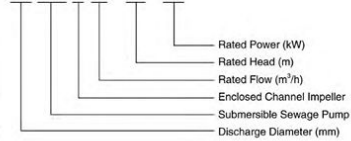

(Hose coupling as standard.
Flange elbow is available on request.)

Technical Data

Model	Power		Discharge mm (inch)	Rated Flow (m ³ /h)	Rated Head (m)	Solid Passage (mm)
	kW	HP				
80SWE40-9-2.2	2.2	3	80 (3")	40	9	30
80SWE40-13-3	3	4	80 (3")	40	13	30
80SWE40-18-4	4	5.5	80 (3")	40	18	30

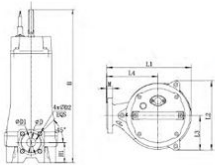

Dimension

Model	L1	L2	L3	L4	H	H1	D	D1	D2	M
80SWE40-9-2.2	266	224	113	160	594	86	80	150	18	18
80SWE40-13-3	266	224	113	160	620	86	80	150	18	18
80SWE40-18-4	266	224	113	160	620	86	80	150	18	18

Hydraulic Performance Curves

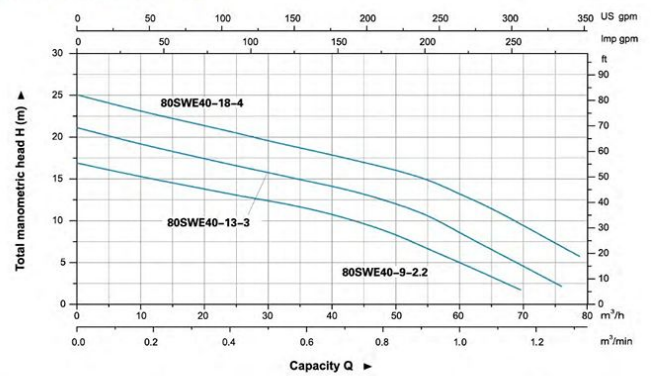

Materials Table

No.	Part	Material
1	Handle	Z5304
2	Upper cover	HT200
3	Upper bearing seat	HT200
4	Motor body	HT200
5	Oil chamber	HT200
6	Pump cover	HT200
7	Pump body	HT200
8	Impeller	HT200
9	Oil seal	
10	Mechanical seal	Upper: PTFE Lower: SS316
11	Bearing	
12	Rotor	
13	Stator	

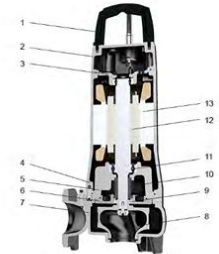

Package Information

Model	GW (Kg)	L (mm)	W (mm)	H (mm)	Quantity (PCS/SW/TEU)
80SWE40-9-2.2	70	848	358	311	294
80SWE40-13-3	68.5	848	358	311	294
80SWE40-18-4	62	848	358	311	294