

XKS

Garden Submersible Pumps

Application

- It can be used to transfer dirty water or other liquids similar to water in physical and chemical properties. It is suitable to be immersed in water for lifting water from the well or the pool, and draining water from the basement.

Pump

- Plastic pump body
- Max. liquid temperature: +35°C
- Float switch ensures automatic cut-in and cut-out
- Max. immersion depth: 7 m
- Max. diameter of particle: 35 mm

Motor

- Motor with aluminum winding
- Built-in thermal protector
- Insulation class: F
- Protection class: IPX8

Identification Codes

XKS - 400 P W



Technical Data

MODEL	POWER		Q (m ³ /h)											
	W	HP	1.5	3	4.5	6	7.5	9	10.5	12	13.5	H (m)		
XKS-400PW	400	0.5	86	78	109	124	150	173	200	225	225			
XKS-550PW	550	0.7	8.2	5.7	5.2	4.5	3.8	3	2.2					
XKS-750PW	750	1	7.5	7	6.5	5.8	5	4.1	3.2	2.2				
XKS-1000PW	1000	1.3	10.4	9.7	8.9	8.1	7.3	6.4	5.4	4.3	3.2			

Dimension

Model	DN	L (mm)	W (mm)	H (mm)
XKS-400PW	32	213	158	332
XKS-550PW		213	158	349
XKS-750PW	40	213	156	349
XKS-1000PW		217	153	376

Hydraulic Performance Curve

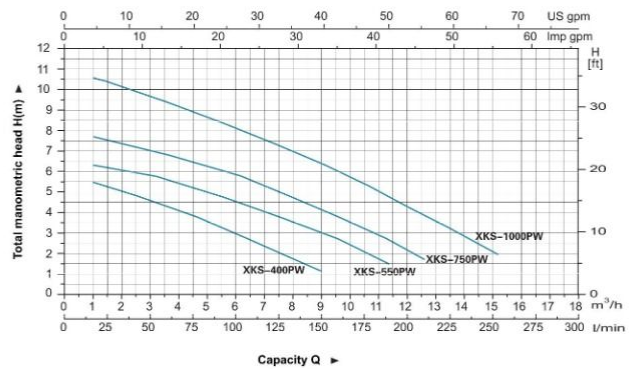

Materials Table

Pos.	Part	Material
1	Upper cover	PP
2	Capacitor	
3	Float switch	
4	Upper plate	ZL102
5	Ball bearing	
6	Rotor	
7	Base plate	PP
8	Pump base	PP
9	O-ring	NBR
10	O-ring	NBR
11	Connector	PP
12	Connector	PP
13	Pump body	PP
14	Impeller	PMG
15	Mechanical seal	Carbon/graphite
16	O-ring	NBR
17	Blower	
18	Oil seal	

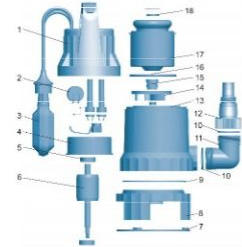

Package Information

Model	GW (Kgs)	L (mm)	W (mm)	H (mm)	Quantity (PCS/20 TEU)
XKS-400PW	4.8	200	150	300	2632
XKS-550PW	5.2	200	150	300	2632
XKS-750PW	6.2	200	150	300	2632
XKS-1000PW	7.8	205	155	345	2160