

# XSP

## Sewage Submersible Pumps



### Application

- Wastewater drainage in factories, construction sites and commercial facilities
- Drainage system in municipal sewage treatment plants
- Drainage station in residential quarters
- Municipal projects
- Methane pools and field irrigation in countryside

### Pump

- Max. immersion depth: 5 m
- Max. liquid temperature: +40°C
- Liquid pH value: 4 – 10
- Liquid kinematic viscosity:  $7 \times 10^{-7} \sim 23 \times 10^{-6} \text{ m}^2/\text{s}$
- Max. liquid density:  $1.2 \times 10^{-3} \text{ kg/m}^3$

### Motor

- Copper winding
- Built-in thermal protector
- Stainless steel welded shaft
- Insulation class: B
- Protection class: IP68

### Identification Codes

**XSP 42 - 17 / 2.2 I**

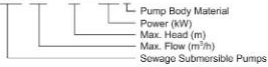

### Technical Data

Model	Power (kW)	HP	Outlet diameter (mm)	Voltage (V/Hz)	Max. flow (m)	Max. head (m)	Max. dia. of particle (mm)	GW (kgs)	Packing dimension (cm)
XSP16.2-22/1.5I	1.5	2.0	40	220/50	270	22	10	27	58.5x35x24.5
XSP42-17/2.2I	2.2	3.0	75	220/50	700	17	20	35	58.5x35x24.5

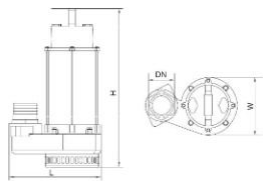

### Dimension

Model	DN	L (mm)	W (mm)	H (mm)
XSP16.2-22/1.5I	50	308	198	530
XSP42-17/2.2I	75	300	190	535

### Hydraulic Performance Curve

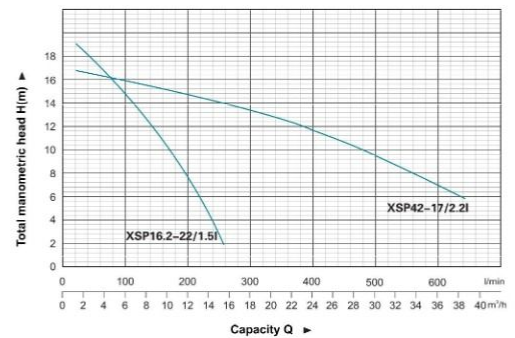

### Materials Table

No.	Part	Material	No.	Part	Material
1	Cap	Stainless steel	30	O-ring	NBR
2	Washer	Stainless steel	31	Stator	Stainless steel
3	Impeller	Stainless steel	32	Switching washer	Stainless steel
4	Lock	Stainless steel	33	Connector part	HT200
5	Nut	Stainless steel	34	Mechanical seal	Carbon/graphite
6	Protector	NBR	35	O-ring	NBR
7	Stator	Stainless steel	36	Oil chamber cover	HT200
8	Washer	Stainless steel	37	Bolt	Stainless steel
9	Capacitor	Stainless steel	38	O-ring	HT200
10	Stator	Stainless steel	39	Impeller	Stainless steel
11	Cable	Stainless steel	40	Washer	Stainless steel
12	Signal	Stainless steel	41	Nut	Stainless steel
13	Cable protector	CPU	42	Bolt	Stainless steel
14	Bolt	Stainless steel	43	Washer	Stainless steel
15	O-ring	NBR	44	Connector	ABS
16	Switching washer	Stainless steel	45	O-ring	NBR
17	Capacitor cover	HT200	46	Connector nut	HT200
18	O-ring	NBR	47	Rubber washer	NBR
19	Capacitor	HT200	48	Pump body	HT200
20	O-ring	NBR	49	Rubber washer	NBR
21	Motor cover	HT200	50	Pump cover	HT200
22	O-ring	NBR	51	Bolt	Stainless steel
23	Thermal protector	HT200	52	Filter mesh	Stainless steel
24	Stator	Stainless steel	53	Shaft	Stainless steel
25	Washer	HT200	54	Float switch	NBR
26	Ball bearing	HT200	55	Cable holder	NBR
27	Impeller	HT200	56	Stator	HT200
28	Key	Steel	57	Switching washer	HT200
29	Ball bearing	HT200	58	Washer	HT200

